

PURE CULTURE IN PUMPING: THE FLUX SANITARY PUMP F427



For use with all FLUX models:

Quick Action Coupling SSK 400 allows a quick assembly/disassembly of motor and pump (not included with the pump – see page 20)

Shaft seal to prevent liquids and/or vapours entering the coupling area

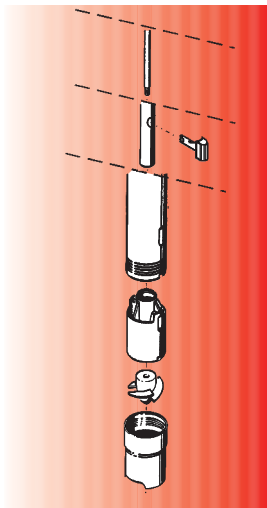

Easy to strip down
– Easy to clean!

FLUX facilitates aseptic pumping of delicate products. The sanitary pump can be stripped down within a few seconds because of its ingenious design.

The F 427 does not have any inaccessible voids.

This allows you to completely clean the pump at any time.

Pressure relief ports

Bottom bearing assembly which centers the shaft within the inner tube

Impeller in ETFE



Closed bearing in PTFE assures safe guiding of the pump



You want a safe pumping of food, cosmetic or pharmaceutical products. The operating conditions require an easy and quick cleaning or sterilization of the pump at regular intervals to avoid any contamination of the product, e.g. when pumping varying liquids or different colours as well as quick-drying or film forming liquids.

The efficient FLUX sanitary pump has been especially designed for aseptic applications.

Special advantages:

- All wetted parts are made in stainless steel, PTFE or ETFE
- The pump can be quickly stripped down for cleaning or sterilization
- Negligible wear by friction on seals and bearings

Here a FLUX sanitary pump is your pump.

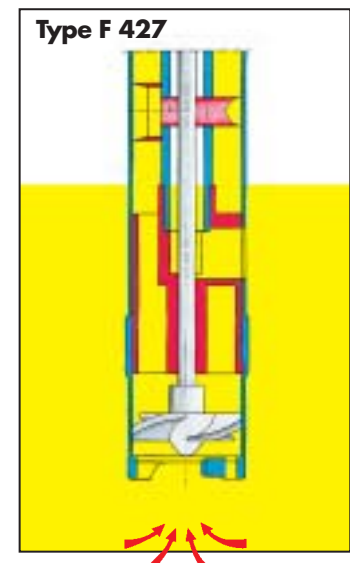

NOTE All FLUX drum pumps are stripped for cleaning with a minimum of effort.

